

REMS Curvo

Teilverzeichnis

Aktueller Stand
siehe www.rems.de

Spare parts list

Latest version
see www.rems.de

Liste des pièces

Situation actuelle
voir www.rems.de

Elenco dei pezzi

Ultimo aggiornamento
vedi www.rems.de

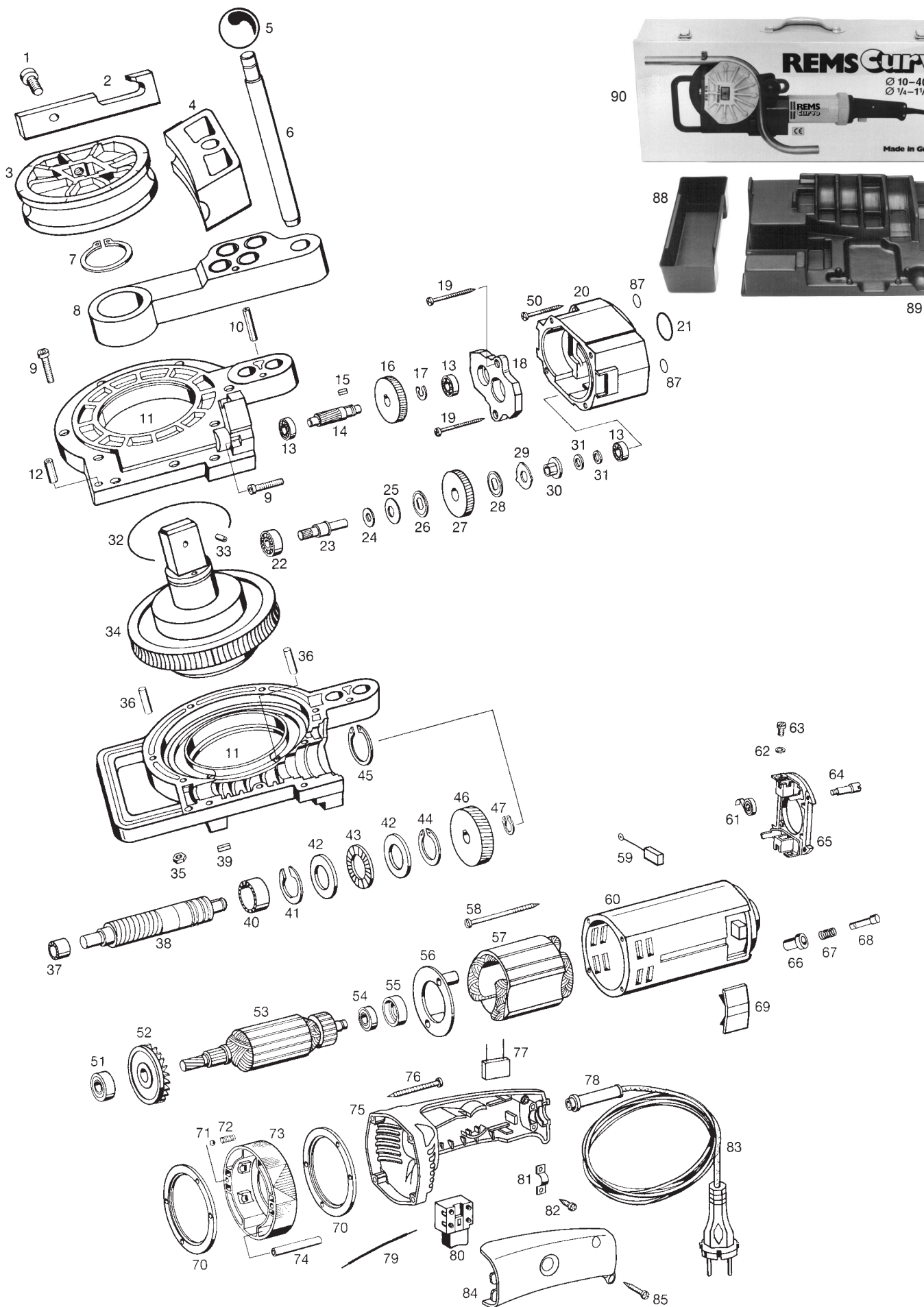

REMS Curvo

	deu		eng		fra		ita		
—	Biegesegment + Gleitstück Pos. 1, 2, 3+4	Ø 10, R 40 Ø 12, R 45 Ø 14, R 50 Ø 15, R 55 Ø 16, R 60 Ø 17, R 56 Ø 18, R 70 Ø 20, R 75 Ø 22, R 77 Ø 22, R 88 Ø 24, R 75 Ø 25, R 98 Ø 26, R 98 Ø 28, R 102 Ø 28, R 114 Ø 30, R 98 Ø 32, R 98 Ø 32, R 114 Ø 35, R 140 Ø 40, R 140 Ø 3/8", R 43 Ø 1/2", R 52 Ø 5/8", R 63 Ø 3/4", R 75 Ø 7/8", R 98 Ø 1", R 98 Ø 1 1/8", R 102 Ø 1 1/4", R 114 Ø 1 3/8", R 140	Former + back former Pos. 1, 2, 3+4	Ø 10, R 40 Ø 12, R 45 Ø 14, R 50 Ø 15, R 55 Ø 16, R 60 Ø 17, R 56 Ø 18, R 70 Ø 20, R 75 Ø 22, R 77 Ø 22, R 88 Ø 24, R 75 Ø 25, R 98 Ø 26, R 98 Ø 28, R 102 Ø 28, R 114 Ø 30, R 98 Ø 32, R 98 Ø 32, R 114 Ø 35, R 140 Ø 40, R 140 Ø 3/8", R 43 Ø 1/2", R 52 Ø 5/8", R 63 Ø 3/4", R 75 Ø 7/8", R 98 Ø 1", R 98 Ø 1 1/8", R 102 Ø 1 1/4", R 114 Ø 1 3/8", R 140	Forme + pièce coulissante Pos. 1, 2, 3+4	Ø 10, R 40 Ø 12, R 45 Ø 14, R 50 Ø 15, R 55 Ø 16, R 60 Ø 17, R 56 Ø 18, R 70 Ø 20, R 75 Ø 22, R 77 Ø 22, R 88 Ø 24, R 75 Ø 25, R 98 Ø 26, R 98 Ø 28, R 102 Ø 28, R 114 Ø 30, R 98 Ø 32, R 98 Ø 32, R 114 Ø 35, R 140 Ø 40, R 140 Ø 3/8", R 43 Ø 1/2", R 52 Ø 5/8", R 63 Ø 3/4", R 75 Ø 7/8", R 98 Ø 1", R 98 Ø 1 1/8", R 102 Ø 1 1/4", R 114 Ø 1 3/8", R 140	Matrice + pezzo scorrevole Pos. 1, 2, 3+4	Ø 10, R 40 Ø 12, R 45 Ø 14, R 50 Ø 15, R 55 Ø 16, R 60 Ø 17, R 56 Ø 18, R 70 Ø 20, R 75 Ø 22, R 77 Ø 22, R 88 Ø 24, R 75 Ø 25, R 98 Ø 26, R 98 Ø 28, R 102 Ø 28, R 114 Ø 30, R 98 Ø 32, R 98 Ø 32, R 114 Ø 35, R 140 Ø 40, R 140 Ø 3/8", R 43 Ø 1/2", R 52 Ø 5/8", R 63 Ø 3/4", R 75 Ø 7/8", R 98 Ø 1", R 98 Ø 1 1/8", R 102 Ø 1 1/4", R 114 Ø 1 3/8", R 140	581400 581410 581420 581430 581440 581110 581450 581080 581460 581470 581130 581180 581270 581070 581310 581150 581280 581320 581350 581330 581200 581210 581220 581230 581240 581250 581260 581320 581350
4	Gleitstück	Ø 10, R 40 Ø 12, R 45 Ø 14, R 50 Ø 15, R 55 Ø 16, R 60 Ø 17, R 56 Ø 18, R 70 Ø 20, R 75 Ø 22, R 77 Ø 22, R 88 Ø 24, R 75 Ø 25, R 98 Ø 26, R 98 Ø 28, R 102 Ø 28, R 114 Ø 30, R 98 Ø 32, R 98 Ø 32, R 114 Ø 35, R 140 Ø 40, R 140 Ø 3/8", R 43 Ø 1/2", R 52 Ø 5/8", R 63 Ø 3/4", R 75 Ø 7/8", R 98 Ø 1", R 98 Ø 1 1/8", R 102 Ø 1 1/4", R 114 Ø 1 3/8", R 140	Back former	Ø 10, R 40 Ø 12, R 45 Ø 14, R 50 Ø 15, R 55 Ø 16, R 60 Ø 17, R 56 Ø 18, R 70 Ø 20, R 75 Ø 22, R 77 Ø 22, R 88 Ø 24, R 75 Ø 25, R 98 Ø 26, R 98 Ø 28, R 102 Ø 28, R 114 Ø 30, R 98 Ø 32, R 98 Ø 32, R 114 Ø 35, R 140 Ø 40, R 140 Ø 3/8", R 43 Ø 1/2", R 52 Ø 5/8", R 63 Ø 3/4", R 75 Ø 7/8", R 98 Ø 1", R 98 Ø 1 1/8", R 102 Ø 1 1/4", R 114 Ø 1 3/8", R 140	Pièce coulissante	Ø 10, R 40 Ø 12, R 45 Ø 14, R 50 Ø 15, R 55 Ø 16, R 60 Ø 17, R 56 Ø 18, R 70 Ø 20, R 75 Ø 22, R 77 Ø 22, R 88 Ø 24, R 75 Ø 25, R 98 Ø 26, R 98 Ø 28, R 102 Ø 28, R 114 Ø 30, R 98 Ø 32, R 98 Ø 32, R 114 Ø 35, R 140 Ø 40, R 140 Ø 3/8", R 43 Ø 1/2", R 52 Ø 5/8", R 63 Ø 3/4", R 75 Ø 7/8", R 98 Ø 1", R 98 Ø 1 1/8", R 102 Ø 1 1/4", R 114 Ø 1 3/8", R 140	Pezzo scorrevole	Ø 10, R 40 Ø 12, R 45 Ø 14, R 50 Ø 15, R 55 Ø 16, R 60 Ø 17, R 56 Ø 18, R 70 Ø 20, R 75 Ø 22, R 77 Ø 22, R 88 Ø 24, R 75 Ø 25, R 98 Ø 26, R 98 Ø 28, R 102 Ø 28, R 114 Ø 30, R 98 Ø 32, R 98 Ø 32, R 114 Ø 35, R 140 Ø 40, R 140 Ø 3/8", R 43 Ø 1/2", R 52 Ø 5/8", R 63 Ø 3/4", R 75 Ø 7/8", R 98 Ø 1", R 98 Ø 1 1/8", R 102 Ø 1 1/4", R 114 Ø 1 3/8", R 140	581404R 581414R 581424R 581434R 581444R 581114R 581454R 581084R 581464R 581474R 581134R 581184R 581274R 581074R 581314R 581154R 581284R 581324R 581354R 581334R 581204R 581214R 581224R 581234R 581244R 581254R 581264R 581324R 581354R
5	Kugelknopf	Knob	Bouton sphérique	Pomello	071007				
—	Steckbolzen mont. Pos. 5 und 6	Socket pin mount. Pos. 5 and 6	Axe debrochable mont. Pos. 5 et 6	Bullone a inniesto mont. Pos 5 e 6	582036				
7	Sicherungsring	Locking ring	Circlip	Anello di sicurezza	059083				
8	Universalabstützung	Support universal	Support universel	Supporto universale	582055RE				
9	Zylinderschraube	Fillister head screw	Vis à tête cylindrique	Vite a testa cilindrica	081093				
10	Spiralspannstift	Spiral pin	Goupille spiralée	Spina elastica	088198				
11	Getriebegehäuse	Gear housing	Boite d'engrenage	Scatola degli ingranaggi	582026R				
12	Spiralspannstift	Spiral pin	Goupille spiralée	Spina elastica	088072				
13	Rillenkugellager	Grooved ball bearing	Roulement à billes	Cuscinetto a sfere	057088				
14	Ritzel	Pinion	Pignon	Pignone	850003A				
15	Paßfeder	Key	Clavette	Chiavetta	849108				
16	Stirrad	Wheel	Roue droite	Ruota dentata cilindrica	532010R220				
17	Sicherungsscheibe	Locking washer	Rondelle de sécurité	Ranella di sicurezza	059042				
18	Lagerplatte	Bearing plate	Plaque d'appui	Piastra di supporto	582018R				
19	Blechschaube	Sheet metal screw	Vis à tôle	Vite da lamiera	083066				
20	Zwischengehäuse	Intermediate housing	Carcasse intermediaire	Carcasa intermedia	570207R				
21	O-Ring	O-ring	Joint torique	Guarnizione O-Ring	060109				
—	Ritzelwelle mit Rutschkupplung Pos. 22–31 und 13	Pinion shaft with safety clutch Pos. 22–31 and 13	Arbre pignon avec embrayage sécurité Pos. 22–31 et 13	Albero pignone a innest. sicurezza Pos. 22–31 e 13	582005				
32	O-Ring	O-ring	Joint torique	Guarnizione O-Ring	060106				
33	Spannhülse	Adaptor sleeve	Douille de serrage	Spina elastica	088131				
34	Spindelrad	Spindle wheel	Roue d'arbre	Ruota albero	582029R				
35	Sechskantmutter	Hexagon nut	Ecrou hexagonal	Dado esagonale	847008				

REMS Curvo

deu	eng	fra	ita		
36	Zylinderstift	Straight pin	Tige cylindrique	Spina cilindrica	088061
37	Nadelhülse	Needle bushing	Douille à aiguilles	Astuccio a rullini	057067
38	Schneckenwelle	Worm	Vis sans fin	Vite senza fina	850004R
39	Paßfeder	Key	Clavette	Chiavetta	582039
40	Nadelhülse	Needle bushing	Douille à aiguilles	Astuccio a rullini	057102
41	Sicherungsscheibe	Locking washer	Rondelle de sécurité	Ranella di sicurezza	059077
42	Laufscheibe	Washer	Rondelle	Ranella	057104
43	Axial-Nadelkranz	Axial needle collar	Cage à aiguilles axiale	Gabbia assiale a rullini	057103
44	Sicherungsring	Locking ring	Circlip	Anello di sicurezza	059012
45	Sicherungsring	Locking ring	Circlip	Anello di sicurezza	059060
46	Stirnrad	Wheel	Roue droite	Ruota dentata cilindrica	542010R220
47	Sicherungsscheibe	Locking washer	Rondelle de sécurité	Ranella di sicurezza	059053
50	Blechschaube	Sheet metal screw	Vis à tôle	Vite da lamiera	083073
51	Rillenkugellager	Grooved ball bearing	Roulement à billes	Cuscinetto a sfere	057004
52	Lüfter	Ventilator	Ventilateur	Ventilatore	535007
—	Anker mit Lüfter 230 V Pos. 52 und 53	Rotor with ventilator 230 V Pos. 52 and 53	Induit avec ventilateur 230 V Pos. 52 et 53	Indotto con ventilatore 230 V Pos. 52 e 53	585006R220
—	Anker mit Lüfter 110 V Pos. 52 und 53	Rotor with ventilator 110 V Pos. 52 and 53	Induit avec ventilateur 110 V Pos. 52 et 53	Indotto con ventilatore 110 V Pos. 52 e 53	585006R110
54	Rillenkugellager	Grooved ball bearing	Roulement à billes	Cuscinetto a sfere	057061
55	Dämmring	Insulating ring	Anneau isolant	Anello isolante	570504
56	Lüfterabdeckung	Ventilator cover	Couvercle du ventilateur	Copertura di ventilatore	565409R
57	Stator 230 V	Stator 230 V	Stator 230 V	Statore 230 V	585005R220
—	Stator 110 V	Stator 110 V	Stator 110 V	Statore 110 V	585005R110
58	Blechschaube	Sheet metal screw	Vis à tôle	Vite da lamiera	083087
59	Kohlebürste (Paar)	Carbon brush (pair)	Balais de charbon (paire)	Carboncini (paio)	535021R
—	Gehäuse kompl. Pos. 60–69	Housing compl. Pos. 60–69	Carcasse compl. Pos. 60–69	Carcassa compl. Pos. 60–69	535025R
—	Isoliering kompl. Pos. 61, 62, 63, 65	Insulating ring compl. Pos. 61, 62, 63, 65	Bague isolante compl. Pos. 61, 62, 63, 65	Anello di isolamento compl. Pos. 61, 62, 63, 65	535016
64	Schraube	Screw	Vis	Vite	535010
66	Buchse	Bush	Douille	Boccola	535012
67	Druckfeder	Pressure spring	Ressort de compression	Molla di compressione	535013
68	Kontaktstift	Contact pin	Fiche de contact	Spina di contatto	535011
69	Abdeckung	Cover	Couvercle	Coperchio	535003R
70	Abdeckring	Sealing ring	Bague-couvercle	Anello di copertura	535009R
71	Stahlkugel	Steel ball	Bille d'acier	Sfera di acciaio	057062
72	Druckfeder	Pressure spring	Ressort de compression	Molla di compressione	535015
73	Stellring	Adjusting ring	Bague d'inversion	Commutatore di rotazione	535004R
74	Distanzhülse	Distance sleeve	Entretoise	Boccola distanziatrice	535014
75	Griff	Handle	Poignée	Impugnatura	565027
76	Blechschaube	Sheet metal screw	Vis à tôle	Vite da lamiera	083066
77	Kondensator	Capacitor	Condensateur	Condensatore	027006
78	Biegeschutz	Rubber sleeve	Douille en caoutchouc	Manicotto di protezione	032057
79	Schalllitze	Reversing strand	Câble comple	Cavetto	535022
80	Schalter 230 V	Switch 230 V	Interrupteur 230 V	Interruttore 230 V	023102R220
—	Schalter 110 V	Switch 110 V	Interrupteur 110 V	Interruttore 110 V	023102R110
81	Bride	Strap	Bride	Linguetta	163130
82	Blechschaube	Sheet metal screw	Vis à tôle	Vite da lamiera	083063
83	Anschlußleitung 230 V	Connecting cable 230 V	Raccordement 230 V	Cavo d'allacciamento 230 V	535037R220
—	Anschlußleitung 110 V	Connecting cable 110 V	Raccordement 110 V	Cavo d'allacciamento 110 V	535037R110
—	Anschlußleitung CH	Connecting cable CH	Raccordement CH	Cavo d'allacciamento CH	535037RSEV
84	Griffdeckel	Handle cover	Couvercle de poignée	Coperchio d'impugnatura	585028
85	Blechschaube	Sheet metal screw	Vis à tôle	Vite da lamiera	083187
87	O-Ring	O-ring	Joint torique	Guarnizione O-Ring	060175
88	Einsatz	Insert	Insertion	Inserto	586006
89	Einlage	Insert	Insertion	Inserto	586005
—	Stahlblechkasten Pos. 88, 89, 90	Steel case Pos. 88, 89, 90	Coffret métallique Pos. 88, 89, 90	Cassetta metallica Pos. 88, 89, 90	586000R
—	Getriebefett 0,5 kg	Gear flow grease 0.5 kg	Graisse à engrenages 0,5 kg	Grasso ingranaggi 0,5 kg	091002R0,5
—	Zange für Sicherungsring	Pliers for locking ring	Pince pour circlip	Pinza per anello di sicurezza	582053
—	Motor kompl. 110 V	Motor compl. 110 V	Moteur compl. 110 V	Motore compl. 110 V	585000R110
—	Motor kompl. 230 V	Motor compl. 230 V	Moteur compl. 230 V	Motore compl. 230 V	585000R220
—	Motor kompl. CH	Motor compl. CH	Moteur compl. CH	Motore compl. CH	585000RSEV